

#16 Drill Parts Break Down

ILLUSTRATION OF PARTS

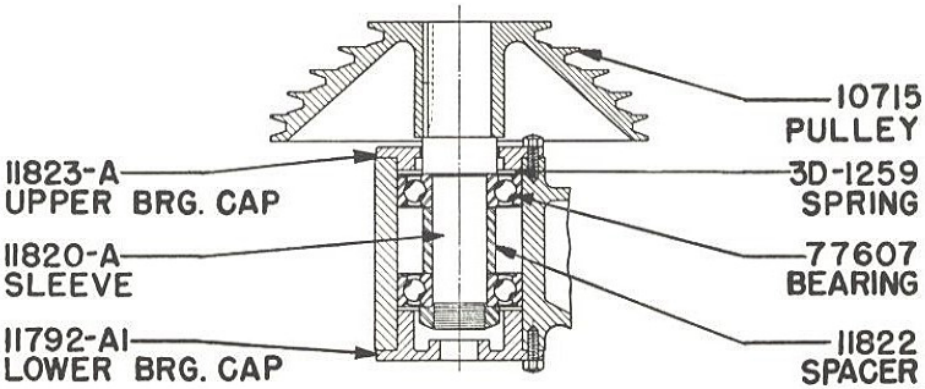
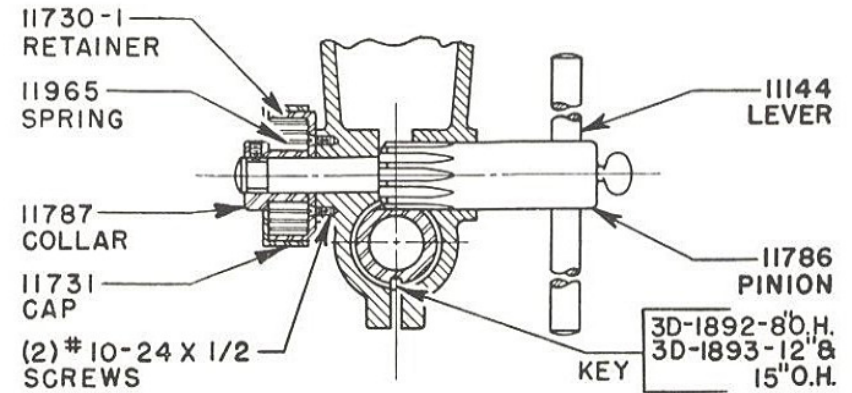
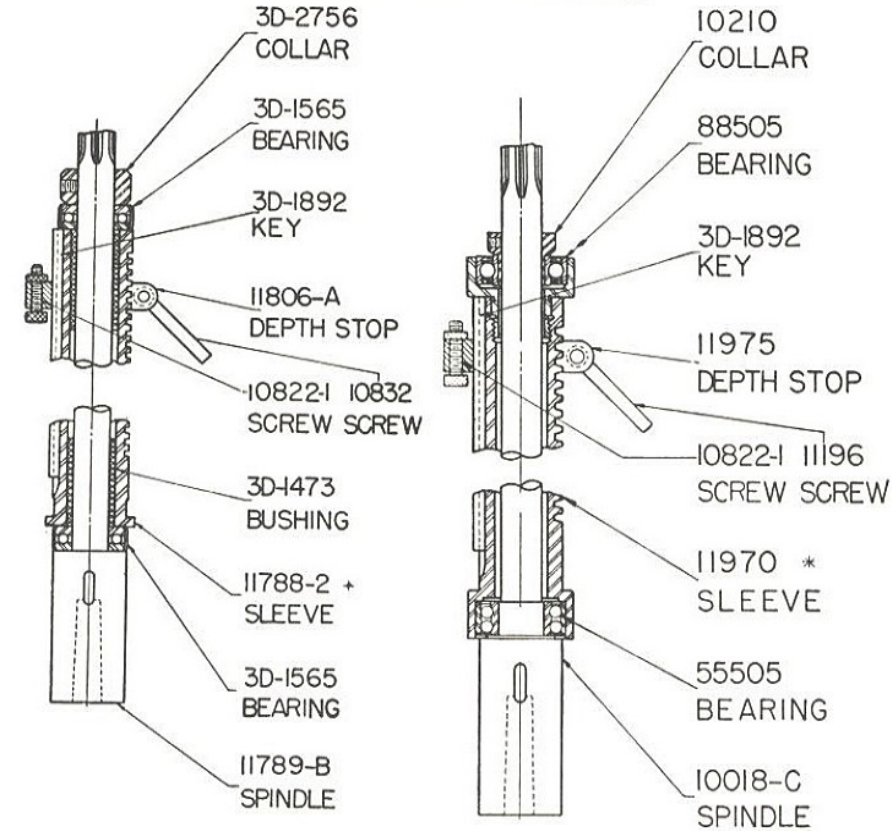

ILLUSTRATION OF PARTS



SPINDLE PULLEY ASSEMBLY



FEED PINION ASSEMBLY

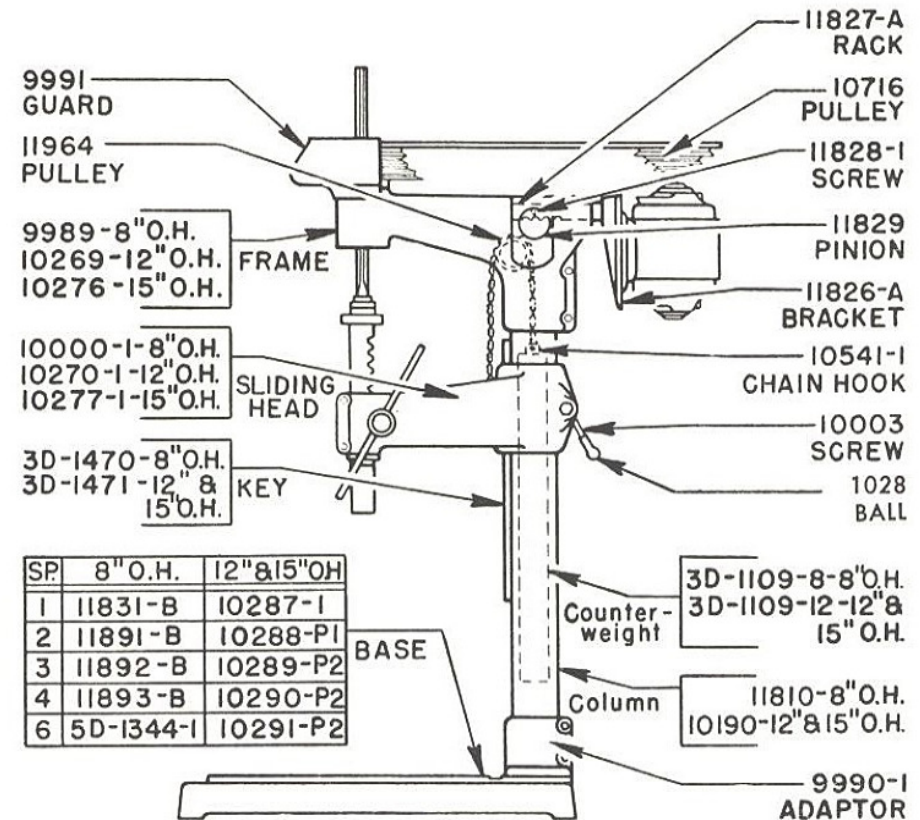

STD. SLEEVE BRG. SPINDLE

BALL BEARING SPINDLE

★Specify whether machine is 8", 12", or 15", overhang.

Exclusive Rights and Ownership of Buffalo Machines, Inc. formerly known as Buffalo Forge Machine Tool Division Any duplication or sale of this information without written permission by Owner, will constitute legal proceedings in accordance with the Copyright Law.

NOT FOR SALE OR DUPLICATION

#16 Drill Parts Break Down

ILLUSTRATION OF PARTS

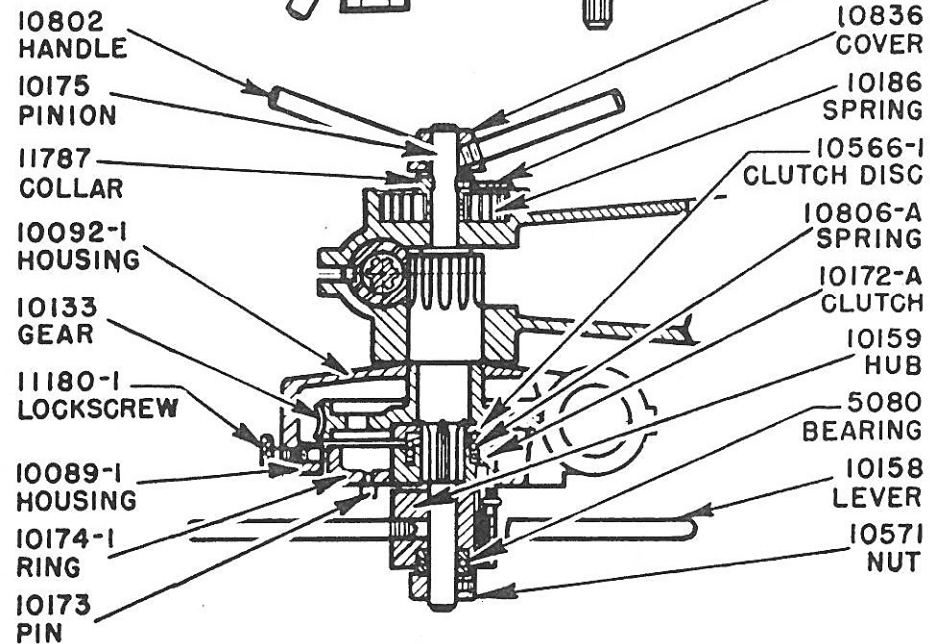
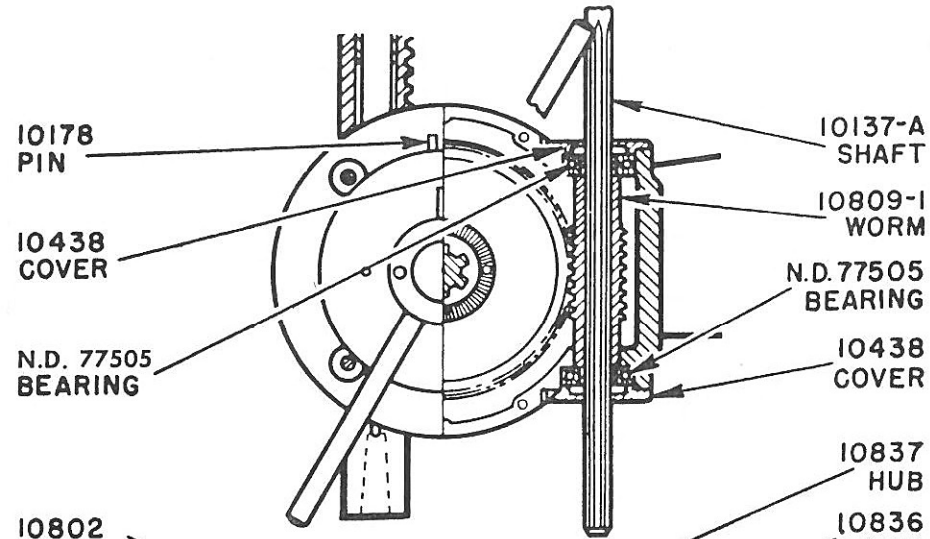
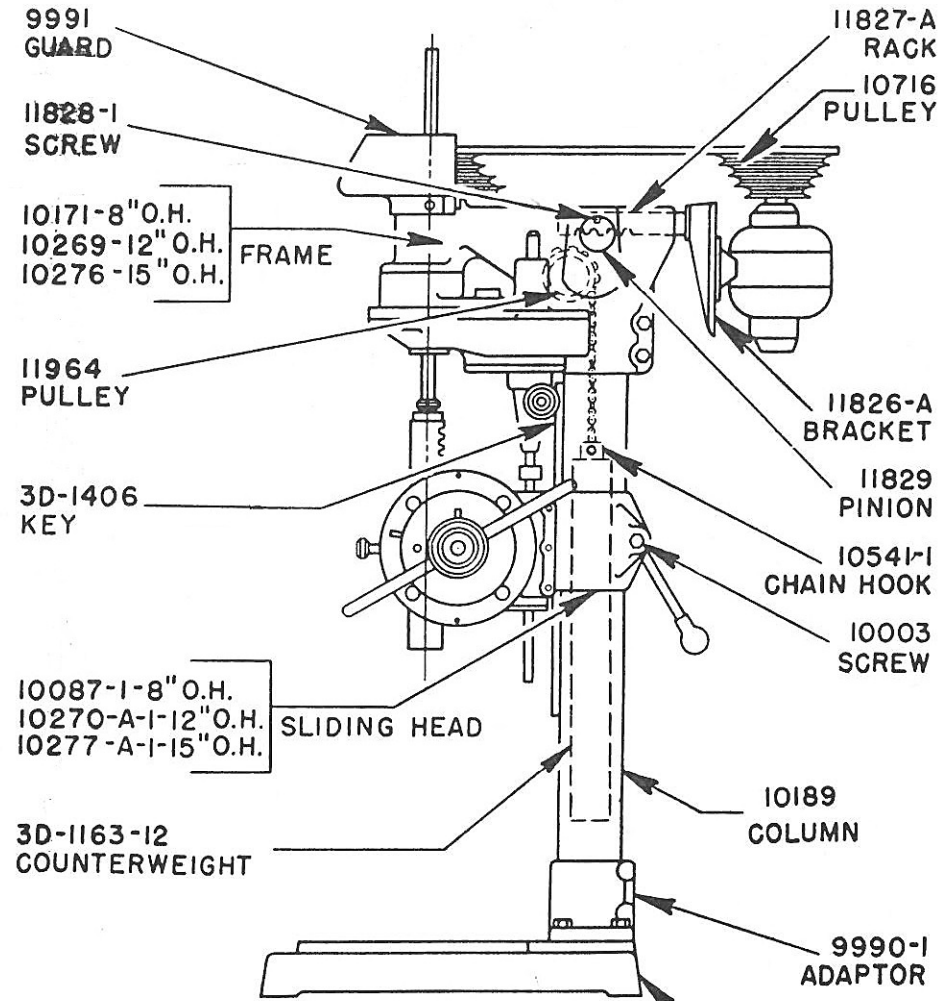

ILLUSTRATION OF PARTS



SP.	8" O.H.	12" & 15" O.H.
1	11831-B	10287-1
2	10304	5D-1913
3	10305	5D-1914
4	10306	7D-1915
6	7D-2615	7D-1734

BASE

#16 Drill Parts Break Down

NO. 16 SENSITIVE DRILL—REPAIR PARTS LIST

Item No.	No. Req'd	Description	Material	Weight Ea. Lbs.
3D-1109-8	1	Counter-weight (8" Overhang)	C. I.	32
3D-1109-12	1	Counter-weight (12" and 15" Overhang)	C. I.	41
3D-1259	2	Loading Spring	Steel	
3D-1470	1	Key for Column (8" Overhang)	Steel	1
3D-1471	1	Key for Column (12" and 15" Overhang)	Steel	1 1/4
3D-1473	2	Bushing for Spindle Sleeve	Bronze	1/2
3D-1565	2	Thrust Bearings	Steel	1/4
3D-1892	1	Key for Spindle Sleeve (8" Overhang)	Steel	1/4
3D-1893	1	Key for Spindle Sleeve (12" & 15" Overhang)	Steel	1/4
3D-2756	1	Spindle Adjusting Collar	Steel	1/2
9989	1	Frame (8" Overhang)	C. I.	42
9990-1	1	Adaptor	C. I.	5
9991	1	Pulley Guard	C. I.	8 1/2
10000-1	1	Sliding Head (8" Overhang)	C. I.	26
10003	1	Locking Screw for Sliding Head	Steel	2 1/2
10018-C	1	No. 2 Morse Taper Ball Bearing Spindle	Steel	7
10190	1	Column-Bench Type, 12" and 15" Overhang	Steel	40
10210	1	Adjusting Collar for Ball Bearing Spindle	Steel	1/2
10269	1	Frame (12" Overhang)	C. I.	49
10270-1	1	Sliding Head (12" Overhang)	C. I.	35
10276	1	Frame (15" Overhang)	C. I.	55
10277-1	1	Sliding Head (15" Overhang)	C. I.	40
10541-1	1	Chain Hook for Counter-weight	Steel	1/4
10715	1	Spindle Pulley	C. I.	26
10716	1	Motor Pulley (specify bore)	C. I.	20
10822-1	1	Depth Stop Adjusting Screw and Nut	Steel	1/4
10832	1	Depth Stop Screw and Handle	Steel	1 1/4
11144	1	Hand Feed Lever	Steel	
11196	2	Nuts for Depth Stop Locking Screw	Steel	1/2
11730-1	1	Spring Retainer	Steel	1/2
11731	1	Cap for Spring Retainer	Steel	1/2
11786	1	Feed Pinion	Steel	4
11787	1	Collar for Feed Pinion	Steel	3/4
11788-2	1	Spindle Sleeve	Steel	9
11789-B	1	Spindle—No. 2 Morse Taper	Steel	8 1/4
11792-A1	1	Lower Bearing Cap	C. I.	2 1/2
11806-A	1	Depth Stop Collar	M. I.	1/2
11810	1	Column (8" Overhang) Bench Type	Steel	34
11820-A	1	Spindle Pulley Sleeve	Steel	6 1/2
11822	1	Spacer	Steel	1/2
11823-A	1	Upper Bearing Cap	C. I.	1 1/2
11826-A	1	Motor Bracket	C. I.	1 1/2
11827-A	1	Rack for Motor Bracket	Steel	4 1/2
11828-1	1	Locking Screw and Knob	Steel	2 1/2
11829	1	Pinion for Motor Bracket	Steel	3/4
11964	1	Pulley for Counter-weight	Steel	1 1/2
11965	1	Spindle Return Spring	Steel	3/4
11970	1	Sleeve for Ball Bearing Spindle	Steel	9 1/2
11975	1	Depth Stop for Ball Bearing Spindle	Brass	1
10287-1	1	1 Spindle Base (12" and 15" Overhang)	C. I.	95
10288-P1	1	2 Spindle Base (12" and 15" Overhang)	C. I.	300
10289-P2	1	3 Spindle Base (12" and 15" Overhang)	C. I.	420
10290-P2	1	4 Spindle Base (12" and 15" Overhang)	C. I.	584
10291-P2	1	6 Spindle Base (12" and 15" Overhang)	C. I.	728
11831-B	1	1 Spindle Base (8" Overhang)	C. I.	97
11891-B	1	2 Spindle Base (8" Overhang)	C. I.	169
11892-B	1	3 Spindle Base (8" Overhang)	C. I.	286
11893-B	1	4 Spindle Base (8" Overhang)	C. I.	364
5D-1344-1	1	6 Spindle Base (8" Overhang)	C. I.	520
1028	1	Ball for Locking Lever	Plastic	
55505	1	Lower Bearing for Ball Bearing Spindle	Steel	1/2
77607	2	Ball Bearing for Frame	Steel	1
88505	1	Upper Bearing for Ball Bearing Spindle	Steel	1/2
	1	V-Belt (In ordering give outside length)	Rubber	1/2

REPAIR PARTS LIST—PEDESTAL TYPE DRILL

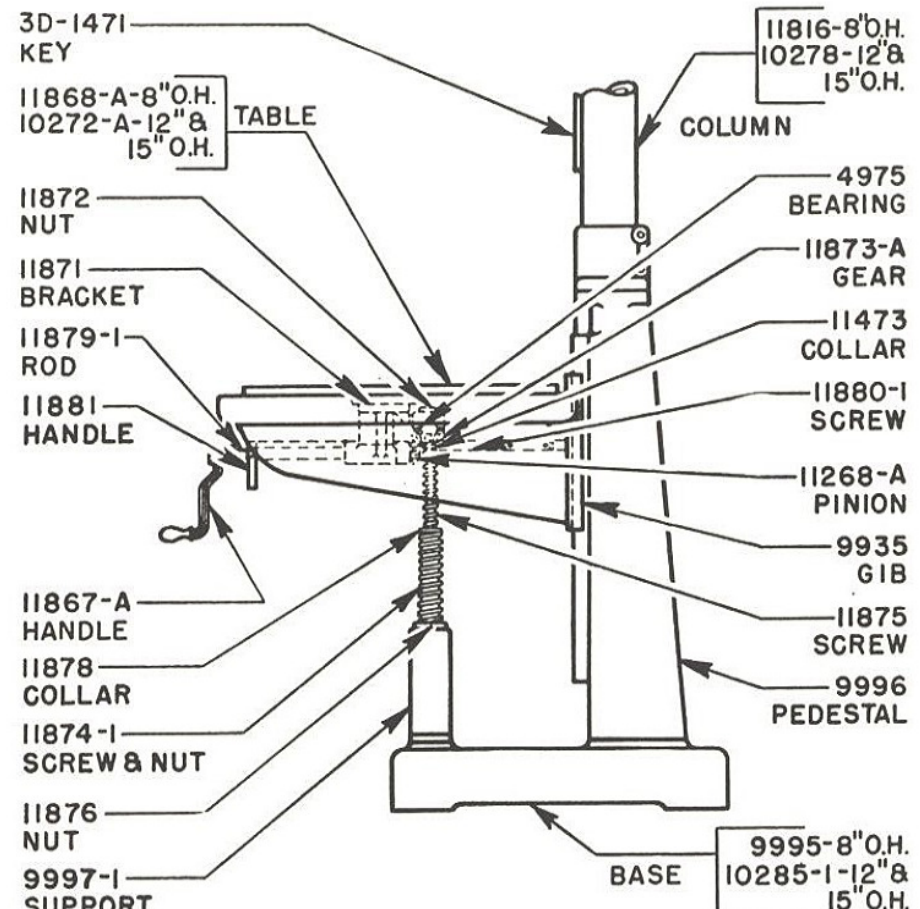

Item No.	No. Req'd	Description	Material	Weight Ea. Lbs.
4975	1	Nice Thrust Bearing	Steel	1/4
3D-1471	1	Key for Column	Steel	1 1/2
9935	1	Gib	Steel	3 3/4
9995	1	Base (8" Overhang)	C. I.	82
9996	1	Pedestal	C. I.	110
9997-1	1	Raising Screw Support	C. I.	6 1/4
10272-A	1	Table (12" & 15" Overhang)	C. I.	245
10278	1	Column (12" & 15" Overhang)	Steel	48 1/2
10285-1	1	Base (12" & 15" Overhang)	Steel	68
11268-A	1	Crown Pinion	Steel	2
11473	1	Set Collar for Small Table Raising Screw	Steel	1/2
11816	1	Column (8" Overhang)	Steel	45 3/4
11867-A	1	Table Raising Handle	Steel	3 1/2
11868-A	1	Table (8" Overhang)	C. I.	120
11871	1	Bracket	C. I.	9
11872	1	Nut for Crown Gear	Steel	1/2
11873-A	1	Crown Gear	Steel	5 3/4
11874-1	1	Large Table Raising Screw and Nut	Steel	8 3/4
11875	1	Small Table Raising Screw	Steel	2 3/4
11876	1	Table Raising Nut for Large Screw	C. I.	2
11878	1	Nut and Collar for Large Screw	Steel	1
11879-1	1	Operating Rod and Collar	Steel	13
11880-1	1	Locking Screw Assembly	Steel	3 1/2
11881	1	Handle for Locking Screw	Steel	3/4

#16 Drill Parts Break Down

REPAIR PARTS LIST—ROUND COLUMN FLOOR DRILL

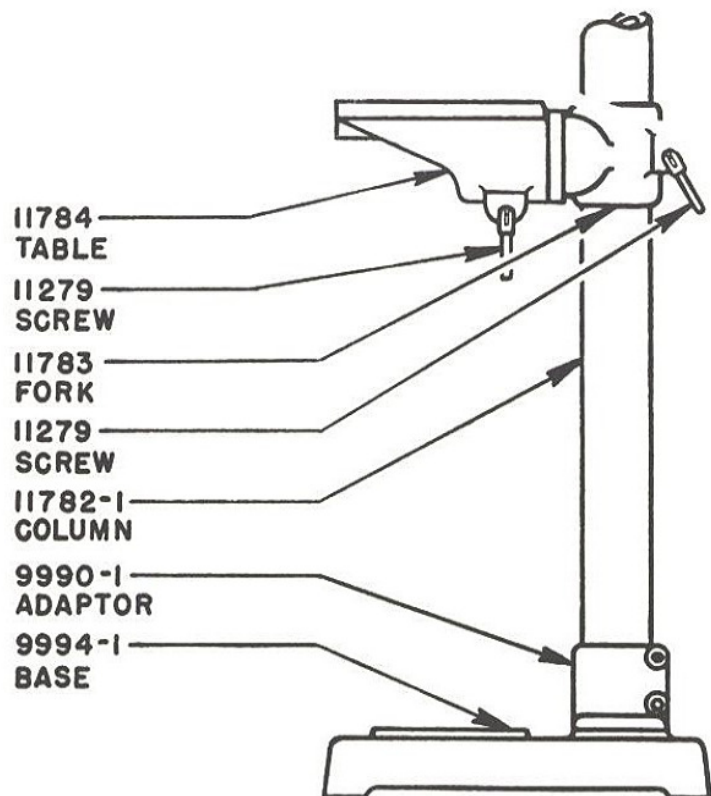

Item No.	No. Req'd	Description	Material	Weight Ea. Lbs.
9990-1	1	Adaptor	C.I.	5
9994-1	1	Base	C.I.	79
11279	2	Locking Screws for Fork and Table.....	Steel	$\frac{1}{2}$
11782-1	1	Column	Steel	62 $\frac{1}{2}$
11783	1	Table Fork	C.I.	19
11784	1	Table	C.I.	41 $\frac{1}{2}$

LUBRICATION—STANDARD SPINDLE

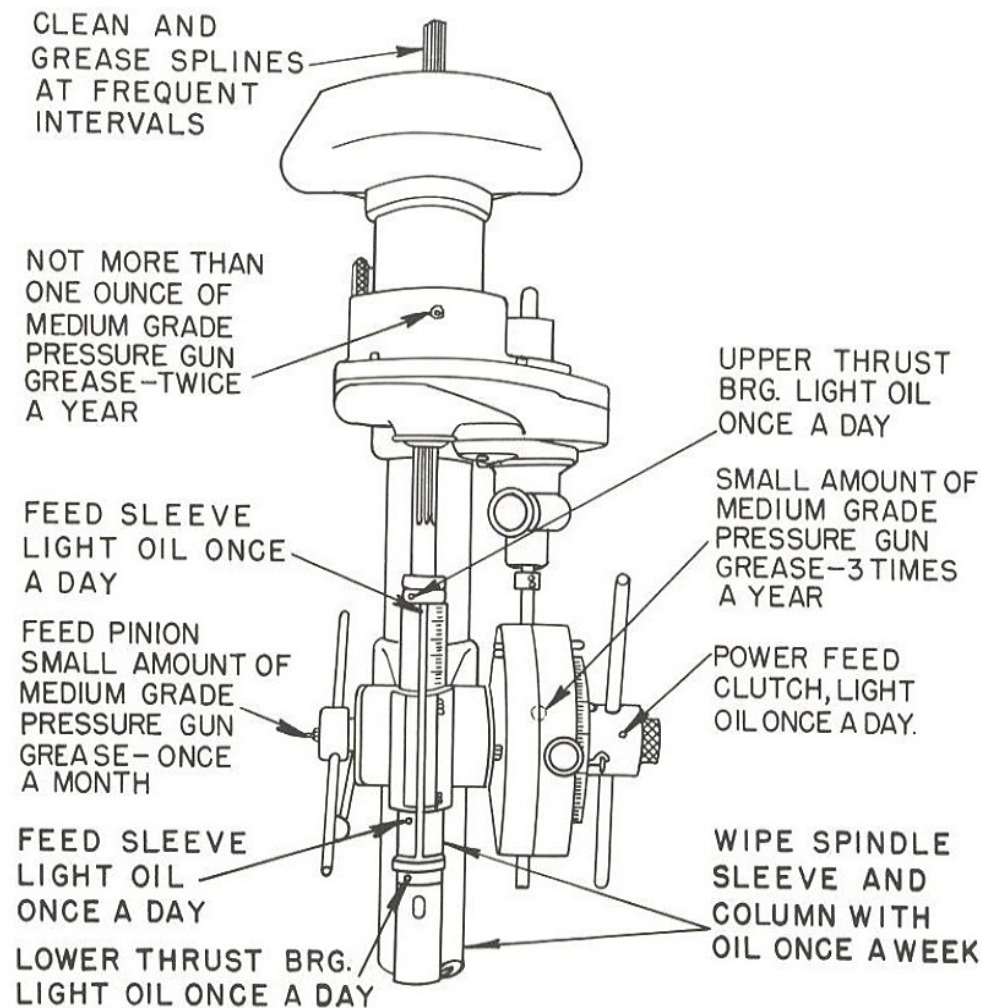

In addition to the Lubrication shown above we recommend the following:

1. Lubricate Table Raising Screw and Gears with soft grease, once a month.
2. Clean Table Gib on Pedestal and wipe with oil, once a month.
3. Lubricate Ball Bearing Motors with a small amount of clean grease, not more often than twice a year.

#16 Drill Parts Break Down

ILLUSTRATION OF PARTS

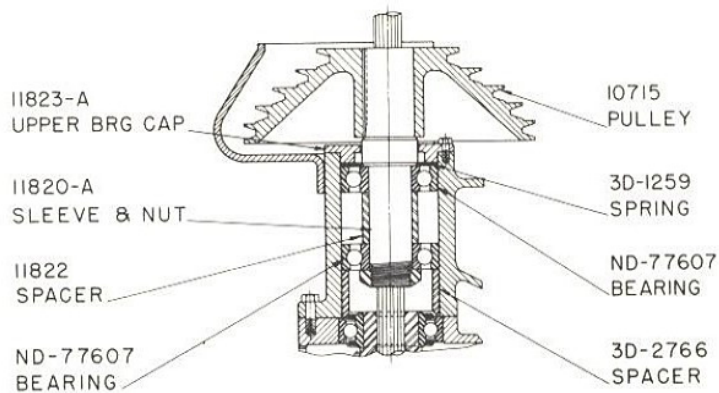

SPINDLE PULLEY ASSEMBLY

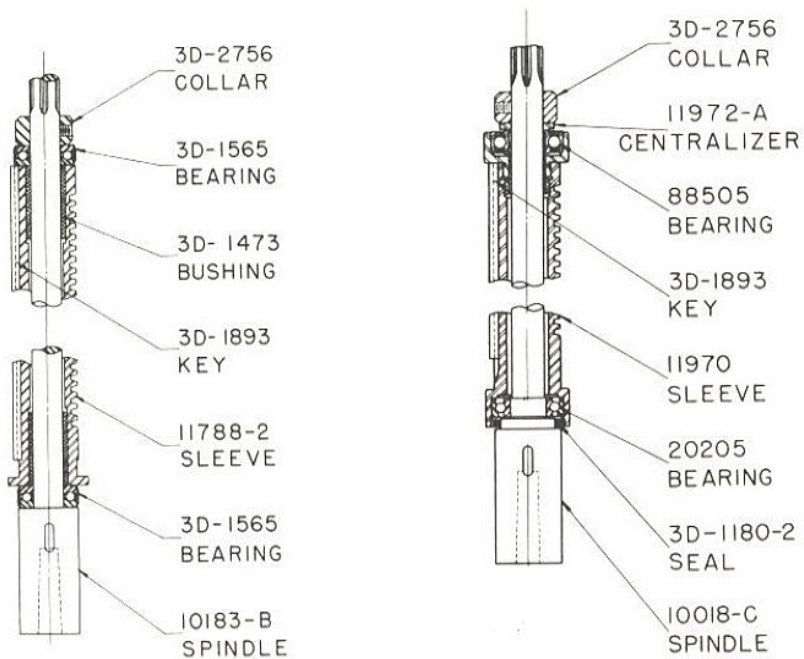

STD. SLEEVE BRG. SPINDLE

BALL BEARING SPINDLE

ILLUSTRATION OF PARTS

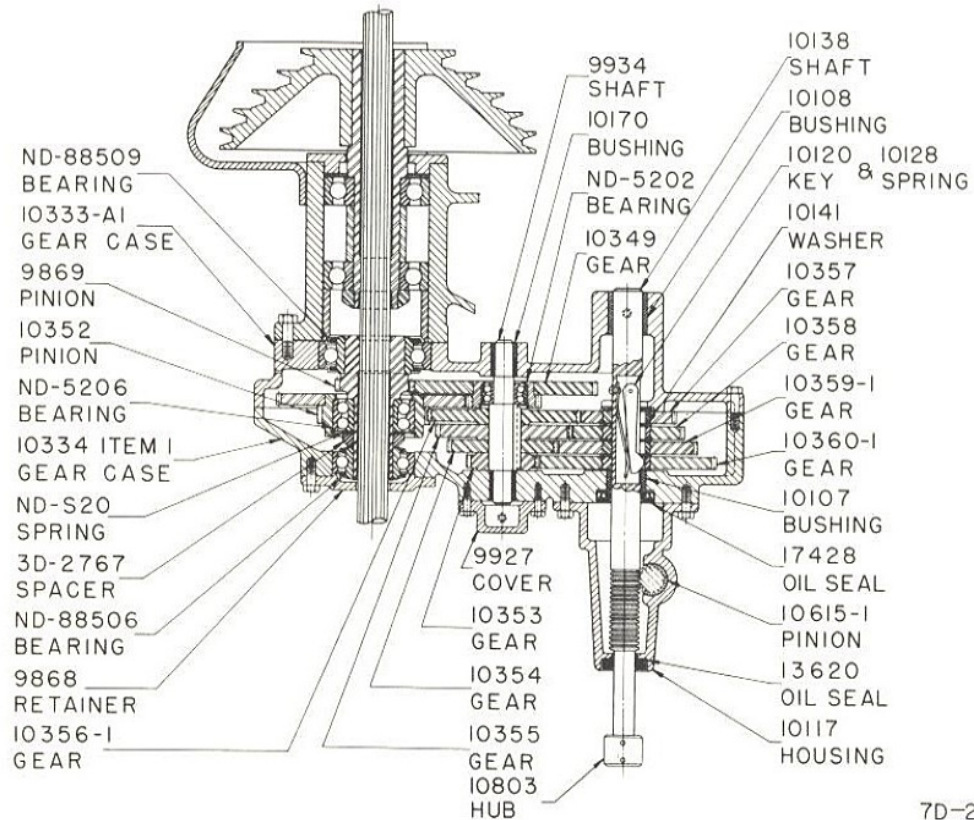

7D-2772



10141 WASHER



10128 SPRING



10122 10140 SNAP RING